

JACUZZI®

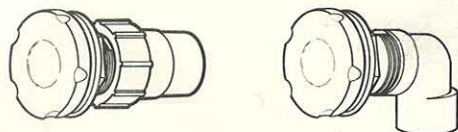

AC3

AC3L

BEFORE PROCEEDING ... CHECK THE CONTENTS

The AC-3 Air Volume Control is comprised of the following parts: 1) Fitting body, 2) Check valve, 3) Jam nut, 4) Straight adapter, 4a) Elbow Adapter, 5) Valve seat "O" ring, 6) Valve seat, 7) Body "O" ring, 8) Mix regulator knob.

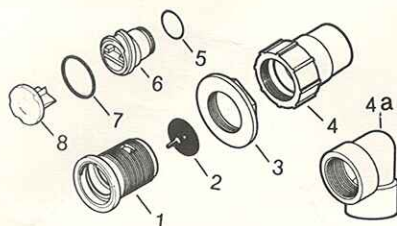

GENERAL INFORMATION

Your new air volume control is a unique design which draws air from under the shell or cabinet minimizing the usual air noise.

The AC-3 is designed to be used on spas, hot tubs and jetted baths. It is available with selective decorative knob finish.

Use the AC-3 to regulate jets in groups or individually.

The AC-3 is designed to operate Jacuzzi Series C, P, W, HT or WHT & Mini Jet Hydro-therapy fittings.

The AC-3 is designed for use with 1" PVC rigid or flexible pipe, as well as 1½" PVC rigid or flexible pipe.

The pipe adapters are molded of PVC, therefore, standard PVC cement is all that is required for securing surfaces to PVC pipe.

LOCATION

Choose a flat surface and one that is on the shell or adjacent deck within easy reach of the user.

OWNER'S MANUAL

INSTALLATION INSTRUCTIONS

AC-3 & AC-3L Air Volume Control

For Spas & Jetted Tubs

INSTALLATION

Using a standard 1-11/16" diameter hole saw, drill hole(s) at desired location(s). Remove all insulation on underside of spa within 1" of hole. Place the body assembly through the hole and secure with jam nut — handtight fit is adequate. DO NOT OVERTIGHTEN.

DO NOT USE PIPE SEALANT on the body or adapter threads. Such compound may come in contact with the check valve. The body incorporates a plastic to plastic seal ring which forms an effective air and water tight seal. Hand tight fit is adequate. DO NOT OVERTIGHTEN.

FOR IN-GROUND FULLY INSULATED SPAS OR OTHER AIR LOCKED INSTALLATIONS.

Provision for air supply must be made to air inlet ports of the AC-3. This can be accomplished with a breather pipe as illustrated below.

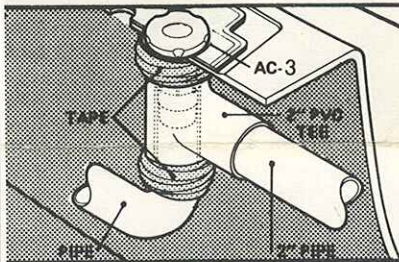

Place a 2" PVC tee over the AC-3 and tape in place. Attach a 2" PVC pipe to the tee locating opposite end of pipe in an unobstructed remote location. Cover this end with a screen. Check this screen periodically, removing any accumulation of dirt and debris.

If insulation or concrete decking is to be used, it is recommended that additional taping around the tee be done to prevent material from clogging air inlet ports.

NOTE: For runs of over 20 feet, increased pipe diameter may be necessary.

RECOMMENDED ADHESIVES

These are examples only and are not intended to restrict brands.

WELD-ON	
ABS-PVC	No. 793 Clear
FLEX PVC-ABS	No. 793 Clear
ABS-ABS	No. 1707 or 2354 Clear
SUREGARD	
PVC-ABS	PVC-2
FLEX PVC-ABS	PVC-2
ABS-ABS	ABS-6

UNIWELD	
CEMENT	
POOL-TITE	No. 2300
PRIMER-CLEANER	No. 7300

COMPLETING INSTALLATION

Attach the air supply line from the jets to the pipe adapter with PVC cement. Hold in place to set. Allow adequate time for adhesive to dry before proceeding.

OPERATION

The AC-3 Air Volume Control is designed to regulate the amount of air supplied to hydro-therapy jets.

The OFF position will allow no air to the jets. To regulate the air flow, simply turn the mix regulator knob clockwise.

When spa is not in use, the mix regulator should be closed to prevent rapid dissipation of sanitizers and to reduce heat loss.

MAINTENANCE

From time to time, it may be necessary to clean the AC-3. This will be evident by increased resistance when adjusting the mix regulator knob. To clean simply remove the regulator knob. Wipe the body of knob and clean the "O" ring with a soft cloth.

Remove valve seat by rotating in clockwise direction. Clean valve seat threads, valve seat o-ring and body valve seat area. Replace any worn parts. Lubricate all parts with silicone lubricant and reassemble.

AC3 AIR VALVE ASSEMBLY

This list is based on Specification CX-0764

ORDERING INFORMATION

Please give the following information when ordering repair parts:

1. Product number;
2. Brief description of part;
3. Quantity required

ENSEMBLE DE SOUPAPE D'AIR AC3

Cette liste est basée sur la spécification CX-0764

RENSEIGNEMENTS POUR COMMANDER

Veuillez donner les renseignements suivants lorsque vous commandez des pièces de rechange:

1. Numéro de produit;
2. Description brève de la pièce;
3. Quantité nécessaire

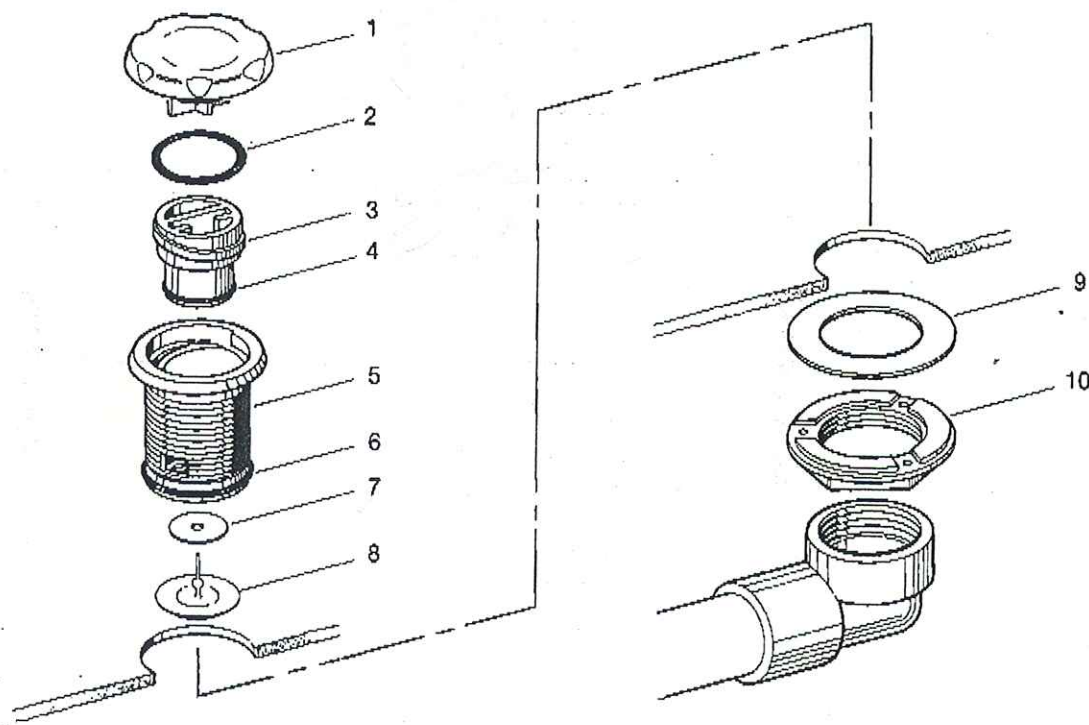

Key No. Légende	Description	Description	Part Number No de pièce	Qty. Qté
1	Air Valve Knob Assy. (Includes control knob, escutcheon and adhesive disc) plus item 2, (O Ring).	Ensemble de soupape (inclus bouton de contrôle, écusson et disque adhésif) plus 2, (anneau en O).	43-1211-02	1
2	O-ring	Anneau en O	47-0218-03	1
3	Air Control Valve Body Assy. (Includes Items 3-8)	Ensemble de soupape de contrôle (inclus 3-8)	43-1209-14	1
4	Valve Seat	Chaise de soupape	43-0772-05	1
5	O-ring	Anneau en O	47-0021-00	1
6	Valve Body (includes Items 6-8)	Corps de soupape (inclus 6-8)	43-2795-12	1
7	O-ring	Anneau en O	47-0028-03	1
8	Reinforcing Disc	Disque renforcement	22-6500-06	1
9	Flow Control Valve	Soupape en forme de parasol	23-2955-04	1
10	Gasket	Joint	13-0486-16	1
	Jam Nut	Écrou à bloquer	14-4106-09	1